



## // FEATURES

- Modular system
- Cross-draught extraction
- Pulse Clean Filters,
- HEPA option

## // CONSTRUCTION

- 2mm steel, fully welded
- Powder coated
- Easily reconfigured

## // APPLICATIONS

Designed for larger parts that cannot be readily handled on an AirBench.

VertEx can be configured for dust or fume applications.

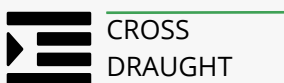

CROSS  
DRAUGHT



MODULAR  
TECHNOLOGY



EC FAN  
TECHNOLOGY



DUST  
EXTRACTION

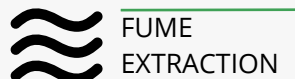

FUME  
EXTRACTION

## FEATURES



### // MODULAR SYSTEM

The unique VertEx modular system allows for rapid build and rapid reconfiguration; or construction of large extracted walls in very short timescales.

### // FILTER OPTIONS

High volume filters with compressed air cleaning system, designed for high volumes of dust - non-explosive dusts only.

Optional H13 HEPA after filter for hazardous dusts.

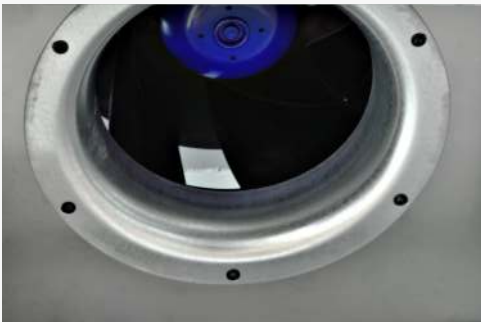

### // HIGH EFFICIENCY FANS

Our low energy fans allow us to move large volumes of air, at low power.

EC Technology permits simple low voltage control, or central management. Single or three phase versions are available at no additional cost.

### // CONTROLS

Ranging from a simple on/off switch on a single unit, to centrally controlled, daisy chained systems for multiple installations.

Speed control is available as a simple option. Every unit is fitted with filter condition monitoring via a pressure loss gauge.



### // BUILD A BOOTH

From a simple extracted wall to a full height extracted booth, constructed within a day using the VertEx modular approach.

## DIMENSIONS

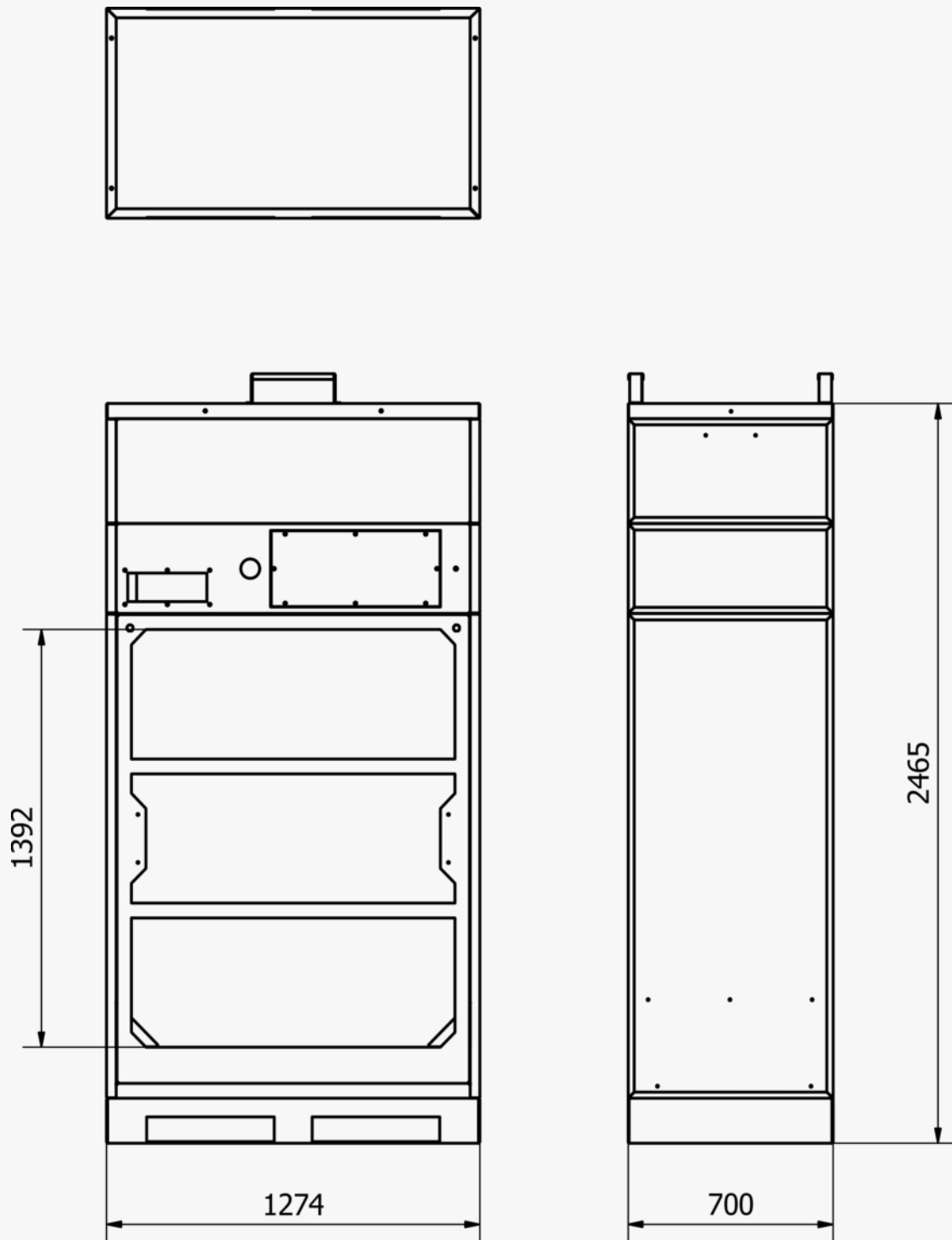

VP121224L Shown - Note ML type also includes HEPA outlet unit

## SPECIFICATIONS

### // TECHNICAL DATA

MODEL	WIDTH	OVERALL		VENTILATED AREA		POWER kw	VOLUME @100Pa
		HEIGHT	DEPTH	WIDTH	HEIGHT		
VP121224M	1270	2465	700	1200	1400	1.48	5100
VP121224ML	1270	2865	700	1200	1400	1.48	5100

### // FILTER OPTIONS

FILTER CLASSIFICATION	FILTERS	
	PRE	FINAL
M Stone Dust & Similar		F7
ML Stone Dust & Similar	F7	H13

### // GENERAL

<b>POWER SUPPLY</b>	240v/1ph - 415v/3ph option	<b>MOTOR</b>	High Efficiency EC Fan
<b>NOISE LEVEL</b>	<70dBA at 1m	<b>FINISH</b>	Textured grey powder coat

### // SEE ALSO

VertEx VA - Modular Cross-Draught System	VertEx Booth - Modular Booth
VertEx VS - Cross-Draught System for Welding/Grinding	